

THERMOFOIL DOOR STYLE

FRAMED CONSTRUCTION FULL OVERLAY

EUROPEAN FRAMELESS CONSTRUCTION FULL OVERLAY

The smooth lines of our thermofoil door styles create a clean look that works in almost any design or décor. Our thermofoil door styles are created through an intense heat and pressure bonding process where rigid vinyl is applied to a sculpted fiberboard to provide a uniform and durable finish.

Features and benefits

- 3D laminate flat panel shaker door style with routed shaker style drawer front
- 5/8" thick melamine-backed doors and drawer fronts
- Solid wood frame finished to match (Framed only)
- Durable and easy to clean
- Full overlay
- Route for glass (RFG) door option available for wall cabinets. Doors prepared for glass do not include glass or glass fasteners.
- Hardware is required

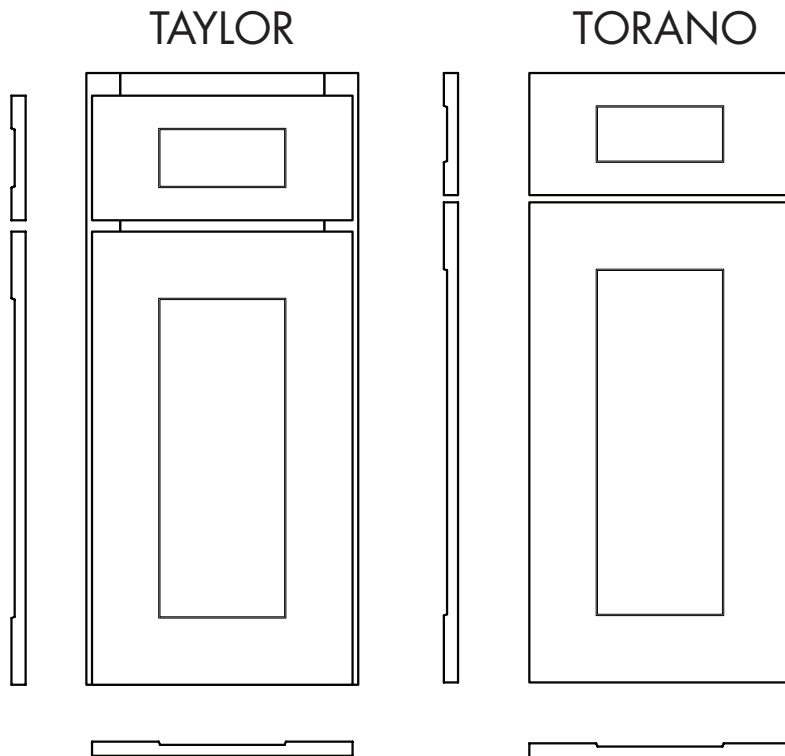

Available in the following colors

