



shown in Chocolate Pecan

SOLARO

THERMOFOIL DOOR STYLE

EUROPEAN CONSTRUCTION / FULL OVERLAY

The simple clean lines of our thermofoil door styles create a clean look that works in almost any design or décor. Our thermofoil door styles are created through an intense heat and pressure bonding process where rigid vinyl is applied to a sculpted fiberboard to provide a uniform and durable finish.

Features and benefits

- 3D laminate flat panel, shaker door style
- 5/8" thick melamine-backed doors and drawer fronts
- Durable and easy to clean
- Full overlay
- Hardware is required

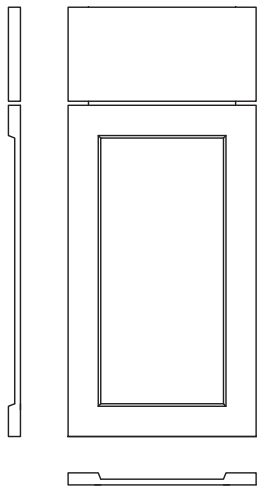

Available in the following colors

Select finishes are available in horizontal patterns. Contact your Leedo sales representative for more details.

					
Ambassador Oak	Baltic Beige	Chocolate Pecan	Dove Grey	Driftwood	Euro Wenge
					
Java	Linea Black	Linea White	Olivewood	Smooth White	Snow White Gloss*
					
Steel Grey	Terra Grey High Gloss*	Vintage Grey	Western Wheat	Wood Grain White	

*Only the door and drawer front material is high gloss.

www.leedo.com 866.GO.LEEDO

©2017 LEEDO CABINERY SOLAROLITSHEET 08/17
Printed in the United States of America



We are building solutions.

NOTE: All photography and illustrations used in this literature sheet should be used for inspiration purposes only. The appearance of actual colors or wood grains may vary due to the printed publication process. Customers are urged to view an actual sample for a realistic representation of wood grains and color tones.