



shown in Coastal Grey

FULTON

THERMOFOIL DOOR STYLE

FRAMED CONSTRUCTION / FULL OVERLAY

The simple clean lines of our thermofoil door styles create a clean look that works in almost any design or décor. Our thermofoil door styles are created through an intense heat and pressure bonding process where rigid vinyl is applied to a sculpted fiberboard to provide a uniform and durable finish.

Features and benefits

- 3D laminate flat panel thin rail shaker door and drawer front
- Shaker rails are 1" wide
- 13/16" thick white melamine-backed doors and drawer fronts
- Solid wood frame finished to match
- Durable and easy to clean
- Full overlay
- Route for glass is not available with this door style
- Not available on cabinets with 9" wide drawers
- Hardware is required

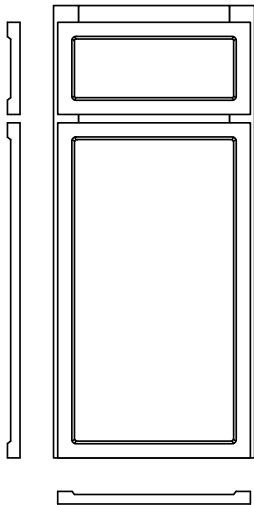

Available in the following colors

						
Alabaster	Baritone	Charcoal LUX	Coastal Grey	Driftwood	Graphite	Libretti
						
Linea Black	Navy LUX	Pebble LUX High Gloss*	Sandy Alder	Steel Grey	Urban Walnut	Vintage Grey
		*Only the door and drawer front material is high gloss.				
White Satin	Wood Grain White					

www.leedo.com 866.GO.LEEDO

©2023 LEEDO CABINERY FULTONLITSHEET 12/23
Printed in the United States of America



NOTE: All photography and illustrations used in this literature sheet should be used for inspiration purposes only. The appearance of actual colors or wood grains may vary due to the printed publication process. Customers are urged to view an actual sample for a realistic representation of wood grains and color tones.



We Are Building Solutions.