

## THERMOFOIL DOOR STYLE

### FRAMED CONSTRUCTION FULL OVERLAY

### EUROPEAN FRAMELESS CONSTRUCTION FULL OVERLAY

The simple clean lines of our thermofoil door styles create a clean look that works in almost any design or décor. Our thermofoil door styles are created through an intense heat and pressure bonding process where rigid vinyl is applied to a sculpted fiberboard to provide a uniform and durable finish.

#### Features and benefits

- 3D laminate flat panel thin rail shaker door style and drawer front
- Shaker rails are 1" wide
- 13/16" thick white melamine-backed doors and drawer fronts
- Solid wood frame finished to match (Framed only)
- Durable and easy to clean
- Full overlay
- Route for glass (RFG) door option is not available.
- Not available on cabinets with 9" wide drawers
- Hardware is required

### FULTON

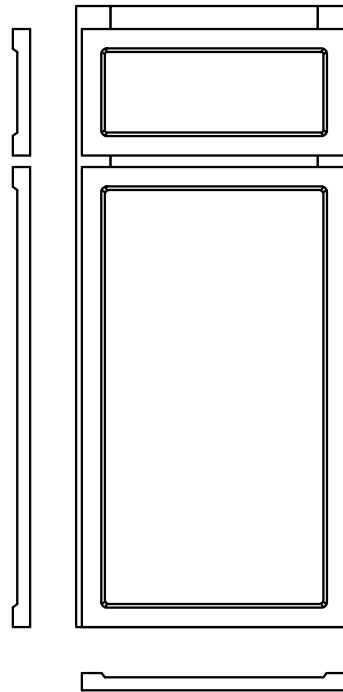

### FORZA

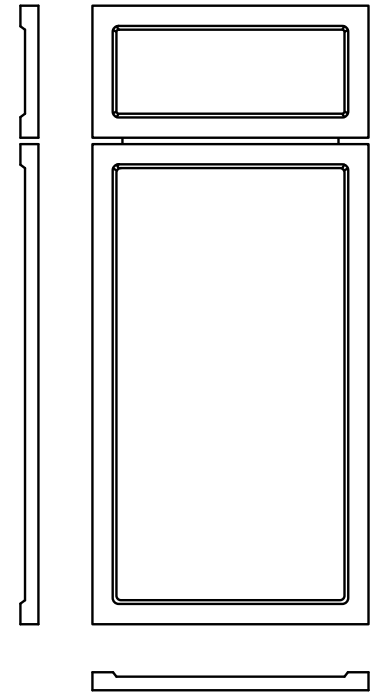

#### Available in the following colors

