



shown in Pebble Lux

SHELBY

THERMOFOIL DOOR STYLE

FRAMED CONSTRUCTION / STANDARD REVEAL

The simple clean lines of our thermofoil door styles create a clean look that works in almost any design or décor. Our thermofoil door styles are created through an intense heat and pressure bonding process where rigid vinyl is applied to a sculpted fiberboard to provide a uniform and durable finish.

Features and benefits

- 3D laminate flat panel, shaker door style
- 5/8" thick melamine-backed doors and drawer fronts
- Solid wood frame finished to match
- Durable and easy to clean
- Standard reveal
- Route for glass door option available for wall cabinets.
Doors prepared for glass do not include glass or glass fasteners
- Hardware is suggested

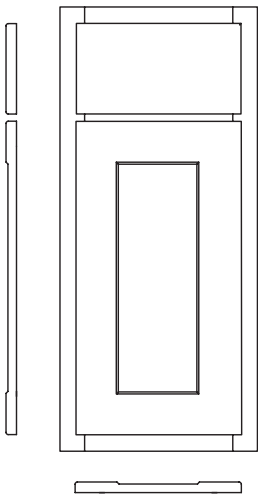

Available in the following colors



Baritone



Coastal Grey

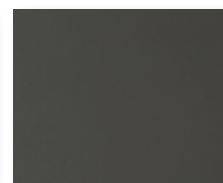

Graphite



Pebble LUX

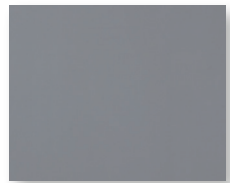

Steel Grey



White Satin

www.leedo.com 866.GO.LEEDO

©2021 LEEDO CABINETS SHELBYLITSHEET 12/21
Printed in the United States of America



NOTE: All photography and illustrations used in this literature sheet should be used for inspiration purposes only. The appearance of actual colors or wood grains may vary due to the printed publication process. Customers are urged to view an actual sample for a realistic representation of wood grains and color tones.

 **Leedo**
CABINETS

We Are Building Solutions.