

## THERMOFOIL DOOR STYLE

## FRAMED CONSTRUCTION STANDARD REVEAL

The smooth lines of our thermofoil door styles create a clean look that works in almost any design or décor. Our thermofoil door styles are created through an intense heat and pressure bonding process where rigid vinyl is applied to a sculpted fiberboard to provide a uniform and durable finish.

### Features and benefits

- 3D laminate flat panel shaker door style
- 5/8" thick melamine-backed doors and drawer fronts
- Solid wood frame finished to match
- Durable and easy to clean
- Standard reveal
- Route for glass (RFG) door option available for wall cabinets. Doors prepared for glass do not include glass or glass fasteners.
- 9" wide doors will have slab styling
- Hardware is suggested

### SHELBY



*shown in Stone*

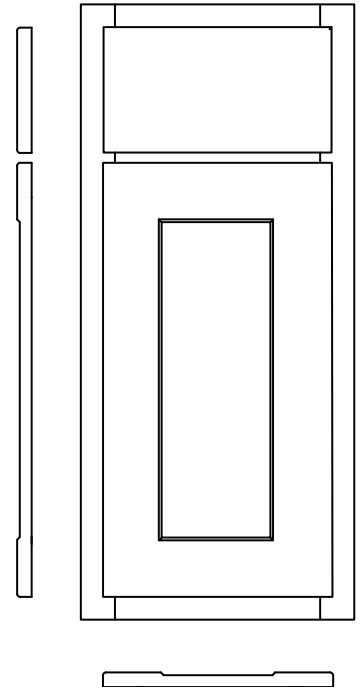

### Available in the following colors

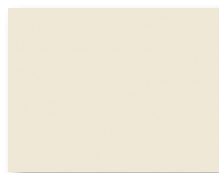

Alabaster

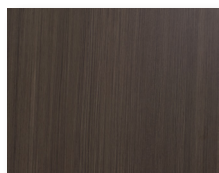

Baritone



Charwood



Coastal Grey



Graphite

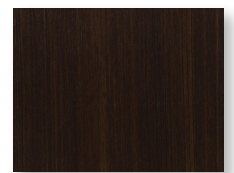

Libretti



Pebblebrook



Sagestone

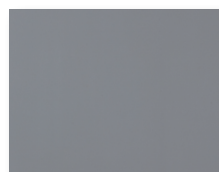

Steel Grey

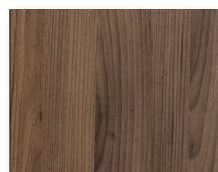

Urban Walnut



White Satin