

THERMOFOIL DOOR STYLE

FRAMED CONSTRUCTION STANDARD REVEAL

The simple clean lines of our thermofoil door styles create a clean look that works in almost any design or décor. Our thermofoil door styles are created through an intense heat and pressure bonding process where rigid vinyl is applied to a sculpted fiberboard to provide a uniform and durable finish.

Features and benefits

- 3D laminate flat panel shaker door style
- 5/8" thick melamine-backed doors and drawer fronts
- Solid wood frame finished to match
- Durable and easy to clean
- Standard reveal
- Route for glass (RFG) door option available for wall cabinets. Doors prepared for glass do not include glass or glass fasteners.
- Hardware is suggested

SHELBY



shown in Pebble LUX

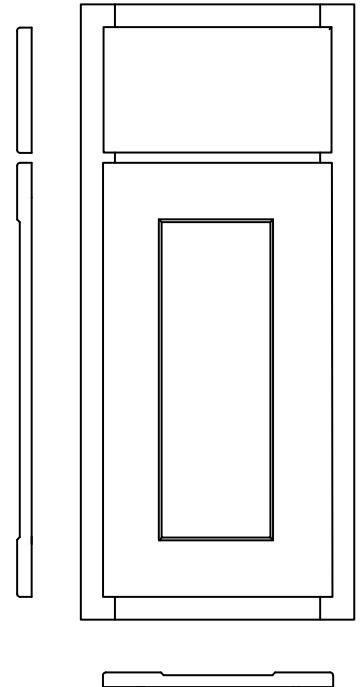

Available in the following colors

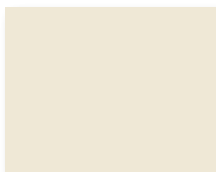

Alabaster

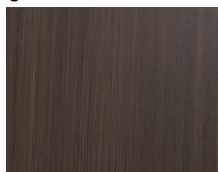

Baritone

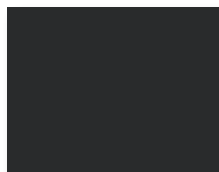

Charcoal LUX



Coastal Grey

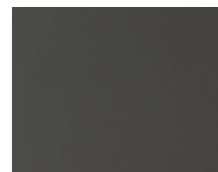

Graphite

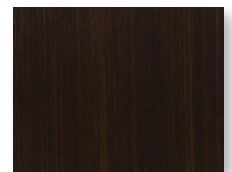

Libretti



Navy LUX



Pebble LUX



Sage

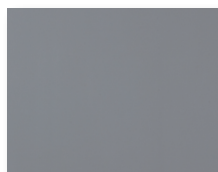

Steel Grey

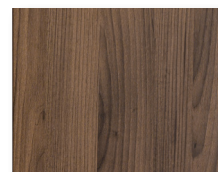

Urban Walnut



White Satin