

## THERMOFOIL DOOR STYLE

FRAMED CONSTRUCTION  
FULL OVERLAY

EUROPEAN FRAMELESS  
CONSTRUCTION  
FULL OVERLAY

The smooth lines of our thermofoil door styles create a clean look that works in almost any design or décor. Our thermofoil door styles are created through an intense heat and pressure bonding process where rigid vinyl is applied to a sculpted fiberboard to provide a uniform and durable finish.

### Features and benefits

- 3D laminate raised panel door style with routed edges
- 5/8" thick melamine-backed doors and drawer fronts
- Solid wood frame finished to match (Framed only)
- Durable and easy to clean
- Full overlay
- Route for glass (RFG) door option available for wall cabinets. Doors prepared for glass do not include glass or glass fasteners.
- Hardware is required

### VANCOUVER

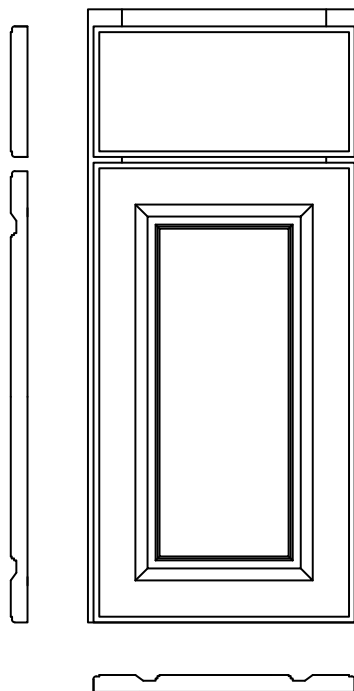

### VITTORIA

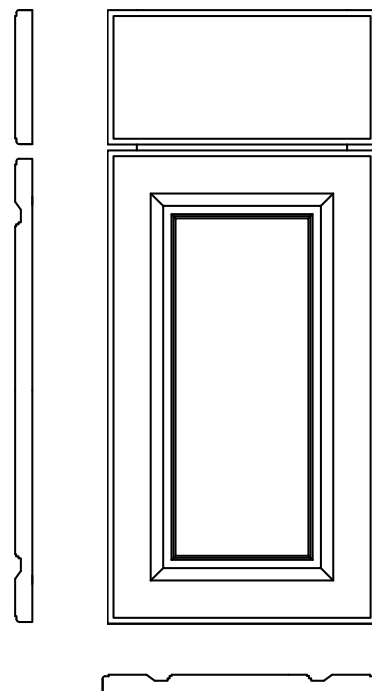

### Available in the following colors



[www.leedo.com](http://www.leedo.com) 866.GO.LEEDO

Printed in the United States of America

0625

NOTE: All photography and illustrations used in this literature sheet should be used for inspiration purposes only. The appearance of actual colors or wood grains may vary due to the printed publication process. Customers are urged to view an actual sample for a realistic representation of wood grains and color tones.